

CONSTRUCTION SIGNS AND WARNING DEVICES - BEDFORD ROAD CULVERT REPLACEMENT

SIGN TYPE	DESCRIPTION	SIZE (WxH) / AREA / COLOR	NUMBER REQUIRED / TOTAL AREA	SIGN TYPE	DESCRIPTION	SIZE (WxH) / AREA / COLOR	NUMBER REQUIRED / TOTAL AREA
R11-3B (1)	BRIDGE OUT AT PHEASANT LANE LOCAL TRAFFIC ONLY	60" x 30" / 12.5 SF / BLACK & WHITE	(2) / 25 SF	W20-2	DETOUR AHEAD	36" x 36" / 9 SF / BLACK & ORANGE	(4) / 36 SF
R11-3B (2)	BRIDGE OUT AT FOXBERRY DRIVE LOCAL TRAFFIC ONLY	60" x 30" / 12.5 SF / BLACK & WHITE	(1) / 12.5 SF	M4-9L	DETOUR	30" x 24" / 5 SF / BLACK & ORANGE	(4) / 20 SF
R11-2B	BRIDGE CLOSED	48" x 30" / 10 SF / BLACK & WHITE	(2) / 20 SF	M4-9R	DETOUR	30" x 24" / 5 SF / BLACK & ORANGE	(4) / 20 SF
W20-3 (1)	ROAD CLOSED 500 FT	36" x 36" / 9 SF / BLACK & ORANGE	(2) / 18 SF	R4-9S	DETOUR	30" x 24" / 5 SF / BLACK & ORANGE	(5) / 25 SF
W20-3 (2)	ROAD CLOSED 1000 FT	36" x 36" / 9 SF / BLACK & ORANGE	(2) / 18 SF	M4-8A	END DETOUR	24" x 18" / 3 SF / BLACK & ORANGE	(3) / 9 SF
W20-3 (3)	ROAD CLOSED AHEAD	36" x 36" / 9 SF / BLACK & ORANGE	(2) / 18 SF	SP-1	BEDFORD RD	30" x 8" / 1.7 SF / BLACK & ORANGE	(13) / 22.1 SF
				SP-2	LOCAL TRAFFIC ONLY	36" x 36" / 9 SF / BLACK & ORANGE	(4) / 36 SF

TRAFFIC CONTROL NOTES:

- PORTABLE CHANGEABLE MESSAGE SIGNS (PCMS) SHALL BE PLACED AND OPERATIONAL FOUR WEEKS IN ADVANCE OF CONSTRUCTION COMMENCING ON BEDFORD ROAD IN ORDER TO GIVE THE PUBLIC ADEQUATE ADVANCED NOTICE OF THE WORK. MESSAGE TO BE DISPLAYED SHALL BE COORDINATED WITH THE ENGINEER. SIGNS SHALL REMAIN IN PLACE THROUGH ROAD CLOSURE.
- PRIOR TO COMMENCING ANY WORK ON BEDFORD ROAD A PRE-CONSTRUCTION MEETING SHALL BE HELD WITH THE TOWN OF NEW BOSTON, INCLUDING REPRESENTATIVES FROM THE HIGHWAY DEPARTMENT, FIRE DEPARTMENT, AND THE POLICE DEPARTMENT IN ATTENDANCE.
- THE CONTRACTOR SHALL BE RESPONSIBLE FOR SUPPLYING, ERECTING AND MAINTAINING TEMPORARY CONSTRUCTION SIGNS, DETOUR SIGNS, ROAD CONES, AND BARRICADES ON THE SITE. REFER TO SIGN PACKAGE SHOWN ON THIS PLAN. TRAFFIC CONTROL DEVICES SHALL BE REMOVED, AND SIGNS SHALL BE COVERED OR REMOVED, WHEN THEY NO LONGER APPLY TO THE EXISTING CONDITIONS. THE USE OF CONSTRUCTION SIGNS AND DEVICES NOT SHOWN ON THESE STANDARDS OR MUTCD, UNLESS APPROVED BY THE ENGINEER, SHALL BE PROHIBITED.
- THE CONTRACTOR SHALL MARK ALL HAZARDS WITHIN THE LIMITS OF THE PROJECT AND CONNECTING ROADS WITH WELL MAINTAINED SIGNS AND WARNING DEVICES. ALL SIGNS AND WARNING DEVICES SHALL BE MOVED, SUPPLEMENTED, CHANGES, OR REMOVED DURING THE PROGRESS OF THE CONSTRUCTION AS NEEDED.
- THE CONTRACTOR SHALL MAINTAIN SAFE, CONTINUOUS ACCESS TO ALL PROPERTIES ADJACENT TO THE PROJECT WORK AREA.
- THE PLACEMENT OF SIGNS AND BARRICADES SHALL BE AS SHOWN ON THESE PLANS AS A GUIDE OR AS OTHERWISE REQUIRED BY THE TOWN OF NEW BOSTON HIGHWAY DEPARTMENT OR POLICE DEPARTMENT.
- THE TOWN OF NEW BOSTON POLICE DEPARTMENT AND ROAD AGENT SHALL DETERMINE THE NEED FOR UNIFORMED OFFICERS OR FLAGGERS DURING CONSTRUCTION.
- THE CONTRACTOR SHALL PROVIDE 24- HOUR PRIOR NOTICE TO THE NEW BOSTON HIGHWAY DEPARTMENT, POLICE DEPARTMENT, AND FIRE DEPARTMENT FOR THE SECTION OF BEDFORD ROAD THAT WILL BE CLOSED FOR CONSTRUCTION AND THE DETOUR ROUTE THAT WILL BE USED FOR THAT DAY.
- SHOULD THE PROPOSED BEDFORD ROAD CONSTRUCTION OCCUR WHILE SCHOOL IS IN SESSION THE CONTRACTOR SHALL PROVIDE NOTIFICATION TO THE NEW BOSTON SCHOOL DEPARTMENT.
- AT THE COMPLETION OF THE EARTH WORK ON BEDFORD ROAD, THE ADEQUATE ROAD SURFACE RESTORATION SHALL BE IMMEDIATELY PROVIDED AS SHOWN ON THESE PLANS. THE CONTRACTOR SHALL MAKE EVERY EFFORT TO OPEN THE ROAD TO THRU TRAFFIC WHEN IT IS SAFE TO DO SO.
- THE FOLLOWING TRAFFIC DETOUR PLAN SHALL BE UTILIZED FOR THE PROPOSED CONSTRUCTION ON BEDFORD ROAD. ALTERNATE DETOUR PROCEDURES MAY BE USED PROVIDED APPROVAL IS GRANTED BY THE NEW BOSTON HIGHWAY DEPARTMENT, POLICE DEPARTMENT, SCHOOL DEPARTMENT, AND FIRE DEPARTMENT PRIOR TO COMMENCING CONSTRUCTION.

TRAFFIC CONTROL LEGEND

- NHDOT ROAD
- TOWN ROAD - PAVED
- TOWN ROAD - UNPAVED
- PRIVATE ROAD
- DETOUR ROUTE
- TYPE III BARRICADE
- TEMPORARY BARRIER
- TEMPORARY CONSTRUCTION SIGN
- WORK AREA
- PORTABLE CHANGEABLE MESSAGE SIGN

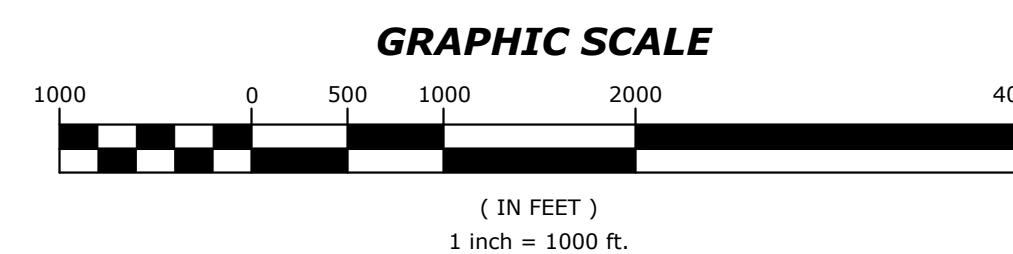

DETOUR ROUTE PLAN
 SCALE: 1"=1000'
 DETOUR ROUTE LENGTH: 4 MILES ±
 STANDARD ROUTE LENGTH: 3.2 MILES ±

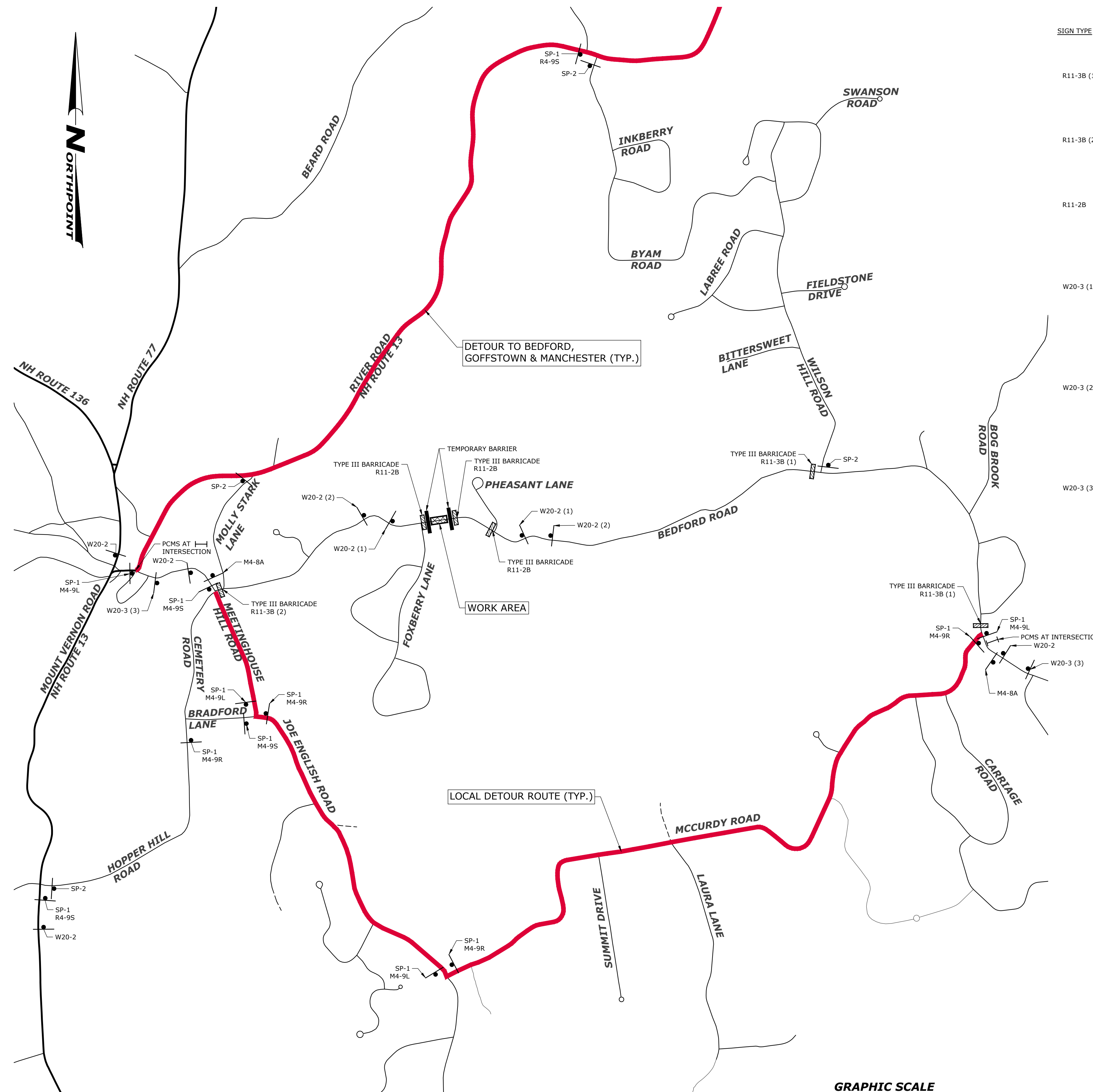

TRAFFIC DETOUR PLAN

PREPARED FOR:

BEDFORD ROAD CULVERT REPLACEMENT
 AT COCHRAN BROOK CROSSING
 NEW BOSTON, NH

APPLICANT:	OWNER: TOWN OF NEW BOSTON P.O. BOX 250 NEW BOSTON, NH 03070																		
<p>REVISIONS:</p> <table border="1"> <thead> <tr> <th>NO.</th> <th>DATE</th> <th>DESCRIPTION</th> </tr> </thead> <tbody> <tr><td> </td><td> </td><td> </td></tr> <tr><td> </td><td> </td><td> </td></tr> <tr><td> </td><td> </td><td> </td></tr> <tr><td> </td><td> </td><td> </td></tr> <tr><td> </td><td> </td><td> </td></tr> </tbody> </table>		NO.	DATE	DESCRIPTION															
NO.	DATE	DESCRIPTION																	

NORTHPOINT ENGINEERING, LLC
 Civil Engineering Land Planning Construction Services

119 Storr's St, Ste 201
 Concord, NH 03301
 Tel 603-226-1166
 Fax 603-226-1160
 www.northpointeng.com

DATE: FEB. 2024
 PROJ.: 20001.5
 SCALE: 1"=1000'
 SHEET: 1 OF 2

FILE: G:\projects\2001\1\New\2001_1\Traffic Detour Plan.dwg BY: Aaron DATE: 17 May 2024 12:35pm

FILE: G:\projects\2001\1\New\2001_1\Traffic Detour Plan.dwg BY: Aaron DATE: 17 May 2024 - 12:35pm

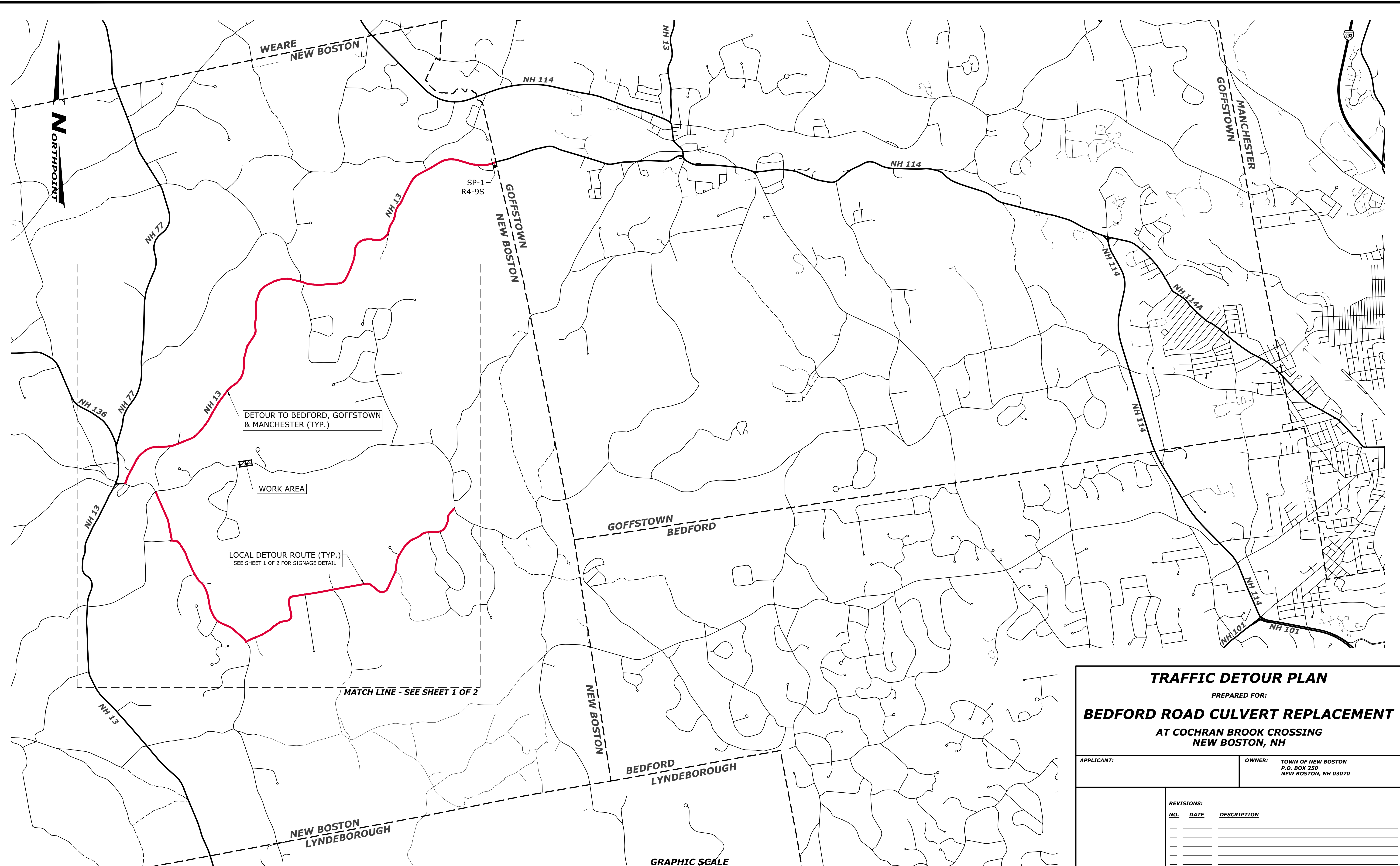

DETOUR TO BEDFORD, GOFFSTOWN & MANCHESTER (TYP.)

WORK AREA

LOCAL DETOUR ROUTE (TYP.)
SEE SHEET 1 OF 2 FOR SIGNAGE DETAIL

MATCH LINE - SEE SHEET 1 OF 2

EXPANDED DETOUR ROUTE OVERVIEW PLAN
SCALE: 1"=2000'

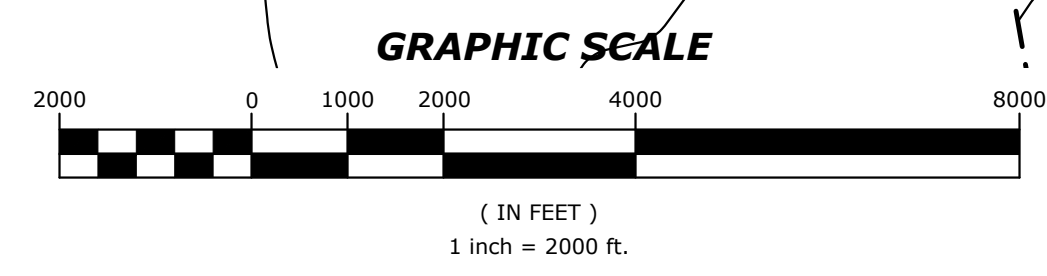

TRAFFIC DETOUR PLAN
PREPARED FOR:
BEDFORD ROAD CULVERT REPLACEMENT
AT COCHRAN BROOK CROSSING
NEW BOSTON, NH

APPLICANT: _____ OWNER: TOWN OF NEW BOSTON
P.O. BOX 259
NEW BOSTON, NH 03070

REVISIONS:		
NO.	DATE	DESCRIPTION

<p>NORTHPOINT ENGINEERING, LLC Civil Engineering Land Planning Construction Services</p>	<p>119 Storrs St, Ste 201 Concord, NH 03301 Tel 603-226-1166 Fax 603-226-1160 www.northpointeng.com</p>	<p>DATE: FEB. 2024 PROJ.: 20001.5 SCALE: 1"=2000' SHEET: 2 OF 2</p>
---	---	---